

LINE TABLE		
LINE #	BEARING	DISTANCE
L1	S87°55'07"W	162.10'
L2	N66°21'32"W	58.32'
L3	N70°09'23"W	390.07'
L4	N28°20'31"W	136.99'
L5	N10°36'17"W	65.80'
L6	S48°48'32"W	173.36'
L7	N67°14'22"W	57.34'
L8	N14°16'51"W	60.23'
L9	N35°06'39"W	205.41'
L10	N80°39'44"W	315.15'
L11	N80°10'55"W	208.65'
L12	N42°27'14"W	297.81'
L13	N18°27'27"E	54.88'
L14	N05°22'27"W	152.21'
L15	N11°06'46"E	380.39'
L16	N03°23'50"E	317.41'
L17	N03°23'50"E	47.72'
L18	N24°06'08"E	75.06'

CURVE TABLE				
CURVE #	RADIUS	ARC LENGTH	CHORD BEARING	CHORD LENGTH
C1	315.000	19.95'	N80° 47' 25"W	19.95
C2	325.000	181.11'	S40° 21' 35"W	178.78
C3	455.000	220.80'	S40° 10' 27"W	218.64
C4	405.000	41.04'	N51° 22' 41"W	41.02
C5	860.000	312.65'	N52° 41' 45"W	310.94
C6	465.000	247.12'	N19° 53' 11"W	244.22
C7	825.000	64.51'	N80° 25' 19"W	64.49
C8	180.000	191.36'	S11° 59' 53"E	182.47
C9	475.000	197.57'	N06° 32' 30"E	196.15
C10	1200.000	345.30'	S02° 52' 10"W	344.11
C11	900.000	121.20'	N07° 15' 18"E	121.10
C12	385.000	139.13'	S13° 44' 59"W	138.37
C13	417.680	209.54'	S38° 28' 26"W	207.35
C14	340.000	338.62'	N24° 18' 50"E	324.80

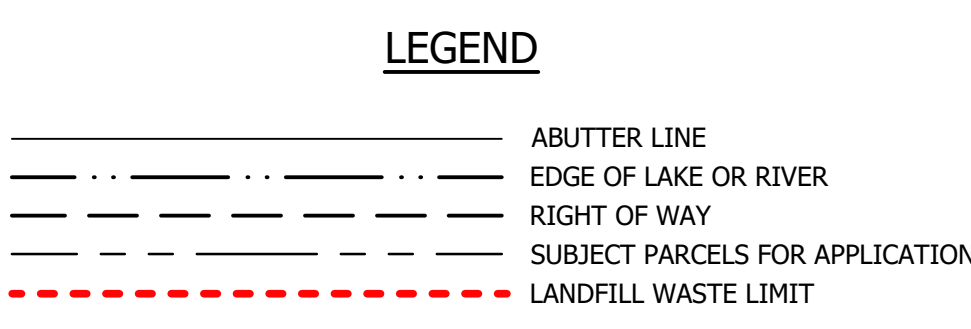
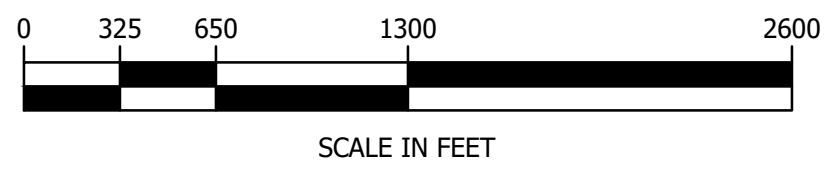

Section Env-Sw 804.04 - Set-back Requirements

- (a) There shall be a minimum 100-foot buffer strip between the property line and the footprint of the landfill.
- (b) There shall be a minimum 300-foot buffer between the footprint of the landfill and Class I and Class II roads and a minimum 100-foot buffer between the footprint of the landfill and Class III through Class VI roads.
- (c) For landfills sited on a parcel of land on which a landfill which is subject to a standard permit exists on the 2014 effective date of this chapter, a minimum distance of 500 feet shall be maintained between the footprint of the landfill and all existing residences not owned by the applicant.
- (d) For facilities approved after the 2014 effective date of this chapter and sited on a parcel of land on which no landfill having a standard permit exists, a minimum 500-foot vegetated buffer shall be established and maintained as provided in Env-Sw 805.11 between the footprint of the landfill and all properties not owned by the applicant or its affiliates that either contain residences or are zoned for residential use.
- (e) The footprint of a landfill receiving putrescible wastes shall not be located within 10,000 feet of any airport runway used by turbojet aircraft or 5,000 feet of any airport runway used by only piston-type aircraft.

N.H. Code Admin. R. Env-Sw 804.04

PLAN SHOWING
PROPOSED COMPLIANCE BOUNDARY
 IN DALTON, NEW HAMPSHIRE
 FOR
GRANITE STATE LANDFILL, LLC
 DOUGLAS DRIVE, DALTON, NEW HAMPSHIRE

horizons
 Engineering
 Engineering - Land Surveying - Environmental
 MAINE • NEW HAMPSHIRE • VERMONT
 www.horizonsengineering.com

STATE OF NEW HAMPSHIRE
 NO. 847
 ANDREW
 MADEAU
 SIGNATURE

PROJECT #:	19045	NO.	DATE	REVISION DESCRIPTION	ENG	DWG
DATE:	JULY 2023		JULY 12 2023	REVISED TO REFLECT CURRENT SUBJECT PARCELS, SETBACK REQUIREMENTS AND LANDFILL WASTE LIMIT.	CMA	KRP
SURVEYED BY:	HEI					
ENGINEERED BY:	HEI/CMA					
DRAWN BY:	SJB/BDD/KRP					
CHECKED BY:	AJN					